



March's Tech tips:

Export to AutoCAD and back to ArchiCAD while retaining your views.

From ArchiCAD:

File > save as > select file format DWG and edit the 'settings' as below.

Create a new translator and name this new translator 'SmartMerge'.

Next open up the 'settings in selected translator' and select the 'save options'. change the 'file format' to 'AutoCAD 2004, 2005, 2006'.

Change the 'save layouts into' to 'paper space with full view's content'.

Change the 'saving floor plan' to 'Prepare file for Smart Merge'. save setting and close, save the DWG document.

Open this DWG in AutoCAD, make changes/add data and save.

Back in ArchiCAD, File > open. Change the file format to DWG select the **Smart Merge** translator and open. Model data, views and layouts are all there linked and intact with the new data added in AutoCAD.

This new AutoCAD data will be in 2D only, but the ArchiCAD original data will be there.

ArchiCAD 12 Hotfix #6 (Build 2782)

ArchiCAD 12 Hotfix #6 (Build 2782) has now been released. It provides fixes to compatibility issues specific to the Mac OS X 10.6 (Snow Leopard) and Windows 7 platforms with additional fixes to other ArchiCAD related problems. Download the Hotfix through the "Check for Updates" command from the Help menu within ArchiCAD.

Please read the release notes with the list of fixed bugs [here](#):

ArchiCAD 13 Hotfix -Build 3259 for BIM Server and ArchiCAD

This Hotfix includes important fixes for bugs discovered since the original release of ArchiCAD 13 (Build 3000) and BIM Server. The Hotfix can be applied to any build of ArchiCAD 13 and BIM Server (Build 3000 and above) but, as always, it is important to read the release notes first, particularly if you are running Teamwork or if you have ArtLantis installed:

[Release notes](#)

Just for laughs

Bite Libraries

The Bite website has been updated with new disabled bathroom fittings and gym equipment ready for download now.

All objects are free to our UAS clients so [log on](#), download and enjoy. If you have any requests for objects please let us know at design@bite.co.uk

Bite News

Studio desk space to hire

We have now converted one of our conference rooms to create a studio on the ground floor of our Nottingham office with 3 Architectural workspaces, complete with workstations, 1600x1200 L shaped desk and all the connectivity you require, telephone, internet, printer and plotter. They are available for rent on a daily, weekly or monthly basis. So if you are a home worker and looking for temporary office space or you want to take some in depth ArchiCAD training by relocating to our offices for a day or a week please ring Ruth on 0115 8404080 for details.

Anshen & Allen cancer centre opens

An £80 million cancer centre designed by Anshen & Allen has opened on London's Harley Street.

The London Clinic is designed to provide state-of-the-art care for cancer sufferers and will feature 47 individual bedrooms and 22 day care pods.

A grade II listed building has also been refurbished to provide consulting rooms.

To read more [click here](#).



Release of Artlantis 3.0.1.

Artlantis 3 has now been updated to version 3.0.1.

This free update focuses mainly on the calculation speed. The acceleration is considerably greater on the Windows platform, where the calculation time has been reduced by 50% compared to version 3.0.

The list of other enhancements and fixes is available in a .pdf attachment, which comes with the download.

ArchiCAD v13 Training offers

Fantastic March Offers



Artlantis Studio £45 beginners training day, 11th March.

Artlantis Studio allows users to quickly create photo realistic, high res renderings, virtual reality scenes and animated sequences. Enrich images with reflection, refraction and transparency effects. Interactively select finishes and apply them to any object in a 3D space.

Our Artlantis Course is conducted over 1 day. A prerequisite for this course is a knowledge of ArchiCAD.

Course outline:

From a model imported from ArchiCAD, you will learn how to apply textures and modify them; how to light the scene and then add realistic objects such as people or trees before setting up the cameras and rendering stills.

Skills Covered... Importing ArchiCAD files. Understanding the interface, Setting up lighting, Editing lights, Copying lights (incl. multi-copy)Heliodon lights, Applying textures, Editing textures, Use of Postcards for storing textures, Moving/Scaling textures, Setting up views/cameras, Render settings, Understanding Radiosity, Adding objects to the scene, Copying/multi-copying objects, Final renders and batch renders.

Artlantis Studio, £100 advanced training day, 23rd March.

Delivered by guest trainer Marin Racic.

A prerequisite for this course is a good knowledge of Artlantis.

Skills Covered... Creating objects, Creating Shaders from external textures, Setting up advanced radiosity settings, Site Insertion and Animation

ArchiCAD training certificate

We are an authorised Training Centre (ATC), and our ArchiCAD training courses are accredited by Graphisoft. Delegates receive an industry recognised certificate from Bite Design to confirm they have attended and successfully completed an accredited ArchiCAD training course.

The update patch can be downloaded from [here](#):

If you would like a specific course, that's not a problem. We can provide tailored courses to suit your needs.

For full Terms and Conditions of all training offers please speak to a member of staff.

When you have time, check out Bite on facebook :)

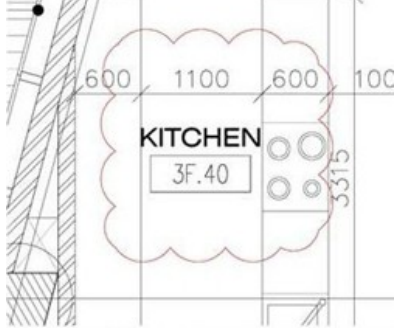

Be carefull when placing revision clouds....
ensure your contractor can read your
drawings.